

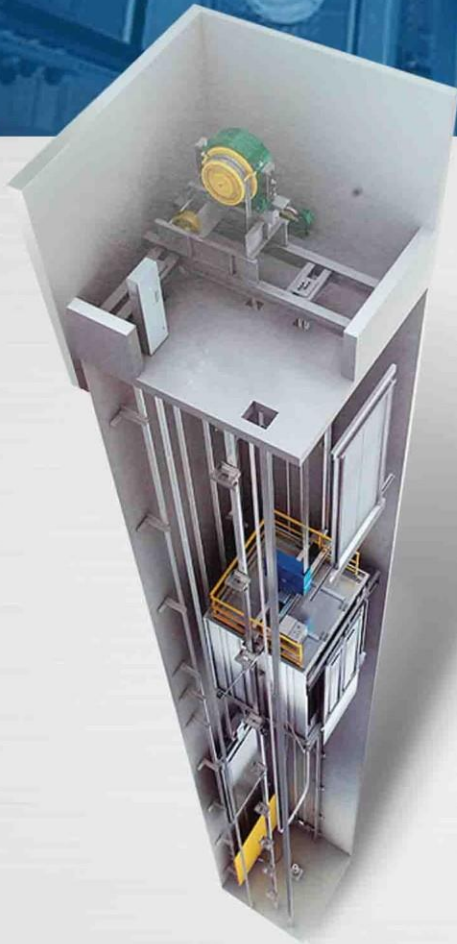

New Installation Lift & All Types of Elevator Maintenance & Modernisations



Providing the Best **Vertical**
Transportation Solutions

- Passenger Elevator
- Capsule Elevator
- MRL Elevator
- Home Elevator
- Hydraulic Elevator
- Hospital Elevator
- Car Elevator
- Goods Elevator



ARKOWN[®]
ELEVATORS



Providing the Best Vertical Transportation Solutions



Producing
High Quality
Products Delivery
On time with
Accurate Quantity
Continuous
Improvement
To satisfy
Our Customer



Certified ISO 9001 : 2008

www.arkown.com

» Company Profile

Arkown Elevators Pvt. Ltd is an ISO 9001 : 2008 certified company promoted by a core group of engineers having vast expertise in installation, retrofitting and maintenance of all types of elevators. Active in the industry since 1990s, we are backed by a pool of engineers and elevator technicians, well experienced in the field of modern elevator technology. We have a rich clientele that include prestigious commercial and residential premises in and around Navi Mumbai, Mumbai and Thane. We provide technically sound solutions that are commercially viable. In addition to Mumbai, we also undertake turnkey projects across India and abroad.

The range of products in our product portfolio include traction, hydraulic and Machine Room Less (MRL) elevators. We use reliable and branded components and strive to provide top of the line services and solutions that are unmatched in the industry today.

Advanced
Technology
Safety &
Reliability



ARKOWN[®]
ELEVATORS

CAPSULE ELEVATOR



Capsule Elevator

Flowing Beautiful Scenes Smooth
and Comfortable Enjoyment



Capsule elevators give an upscale, attractive feel to offices, shopping malls, multiplexes and other prestigious buildings. These lifts owe their stunning looks to the large glass viewing panels which provide entertaining ride to passengers.

Capsule elevators work just as well as small personal lifts for private homes as they do in large office and commercial buildings. Installation on the exterior face of the building or in the lobby will totally change the look of a building. And of course, they incorporate state-of-the-art technology.



3 Glass Panels On Rear

Dimension

| PERSONS | 8 | 10 | 13 | 16 | 20 |
|---------|---------|---------|---------|----------|---------|
| LOAD | 544 KG. | 660 KG. | 884 KG. | 1088 KG. | 1360 KG |
| A | 1100 | 1350 | 1350 | 1600 | 1600 |
| B | 1400 | 1400 | 1700 | 1700 | 2000 |
| C | 2350 | 2600 | 2600 | 2800 | 3050 |
| D | 1300 | 1300 | 1600 | 1600 | 1900 |
| E | 800 | 800 | 900 | 1000 | 1000 |
| F | 2200 | 2200 | 2500 | 2500 | 2800 |

OWNER'S WORK

1. All Walls Minimum 150 Rcc Or 230 Brick (H.Y. Front Wall 230 Bk. Preferred)
2. All Civil Work, Holes, Grouting Etc.
3. Suitable Rain Protected Encloser for Full Height of Hoistway as Elevator Equipment is Not Suitable for Exposed Environment.
4. Reinforced Concrete Machine -room Structural Floor Slab 150 Thick Designed To Sustain Min. 1000 Kg / M2 U.D.L.
5. Rolled Steel Section For Hoisting Beams. Machine Beams. Bearing Plats & Support Beam Etc.
6. Power Supply 400 Volts. 3 Phase. 4 Wires. 50 Hz & 230 Volts 1 Phase.

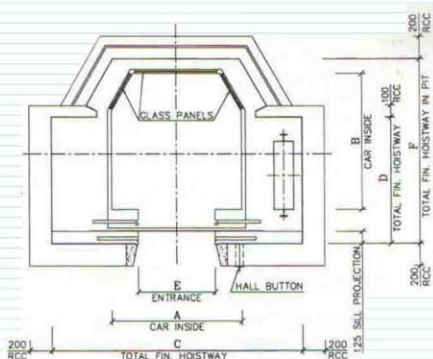

Hoistway Plan

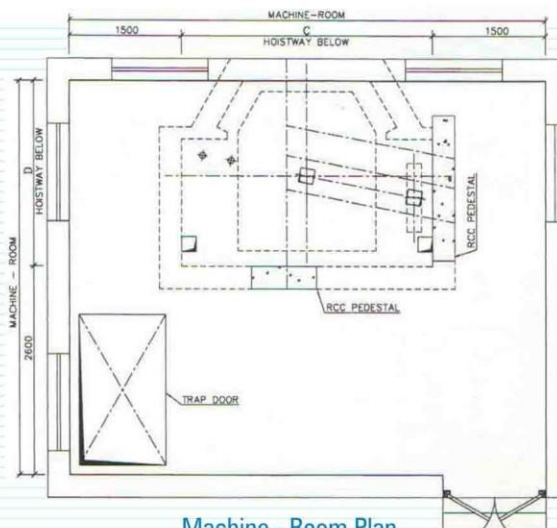

Machine - Room Plan

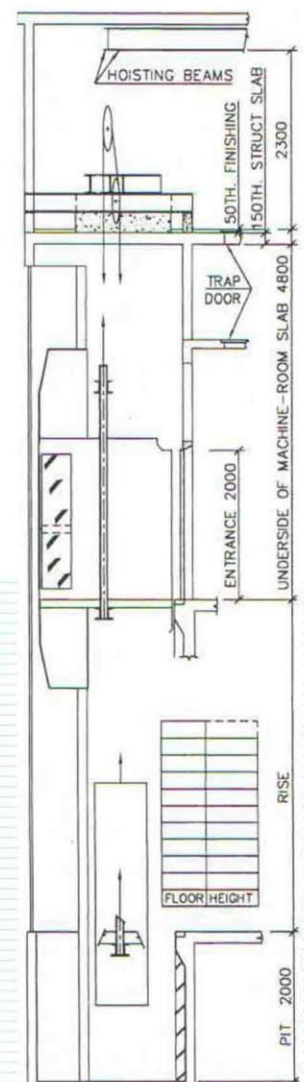

Elevation



Capsule Elevator

Features :

- ▶ Glass / Stainless steel / designer stainless steel / gold finish stainless steel.
- ▶ Powder coated (multi-color) cars and doors, elegant in looks, light in weight, and variable speed options.
- ▶ Microprocessor based controller with full collective-selective control.
- ▶ AC VVVF drive for smooth operations and variable speeds.
- ▶ Over load indications and floor announcement system.
- ▶ Infrared curtain for door safety.
- ▶ Automatic rescue device for power back up (ARD).
- ▶ Luminous push button / touch buttons, which are highly attractive and durable.
- ▶ Digital / LCD floor indication in LOP & COP.
- ▶ Decorative LED lights with suspended ceilings.
- ▶ PVC / Marble / granite flooring.
- ▶ Blower fan for multi-cross air delivery.



Five Glass Panels On Rear

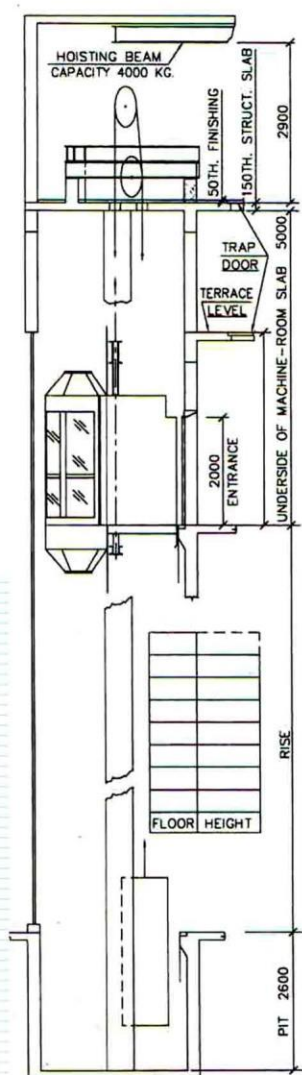

Elevation

Dimension

| Load | A | B | C | D | E | F | G |
|----------|------|------|------|------|-----|------|------|
| 884 kg. | 900 | 2100 | 2700 | 122 | 800 | 2800 | 1600 |
| 1088 kg. | 1100 | 2200 | 3000 | 1250 | 900 | 3000 | 1700 |

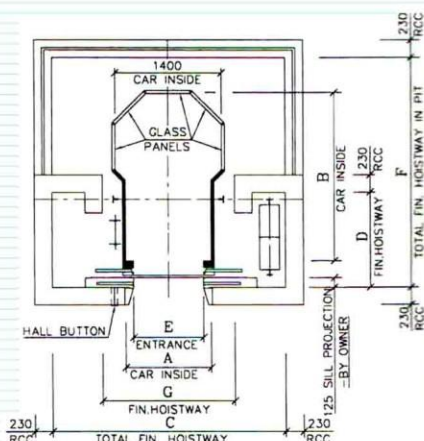

Hoistway Plan

OWNER'S WORK

1. All Civil Work, Holes, Grouting Etc.
2. Dry Pit Reinforced to Sustain Total 38200 Kg. Reaction Load.
3. Reinforced Concrete Machine-room Structural Floor Slab 150 Thick Designed to Sustain Min. 1000 Kg./m
4. Suitable Rain Protected Enclosure For Full Height of Hoistway As Elevator Equipment Is Not Suitable for Exposed Environment
5. Rolled Steel Section For Hoisting Beams, Machine Beams, Support Beams, Bearing Plates, Insert Plates Etc.
6. Power Supply 400 Volts, 3 Phase, 4 Wires, 50 Hz & 230 Volts 1 Phase.

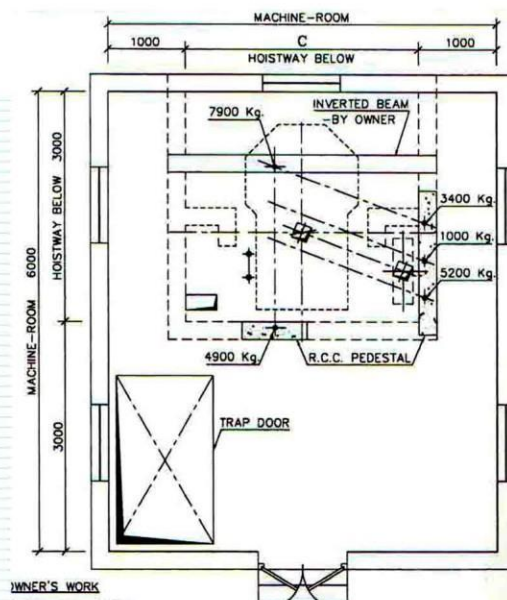

Machine - Room Plan



Passenger Elevator Manual Door

Manual Passenger Elevators economically suited for all type of Residential & Commercial Buildings depending upon the shaft size with speed / amenities up to the choice of owners.

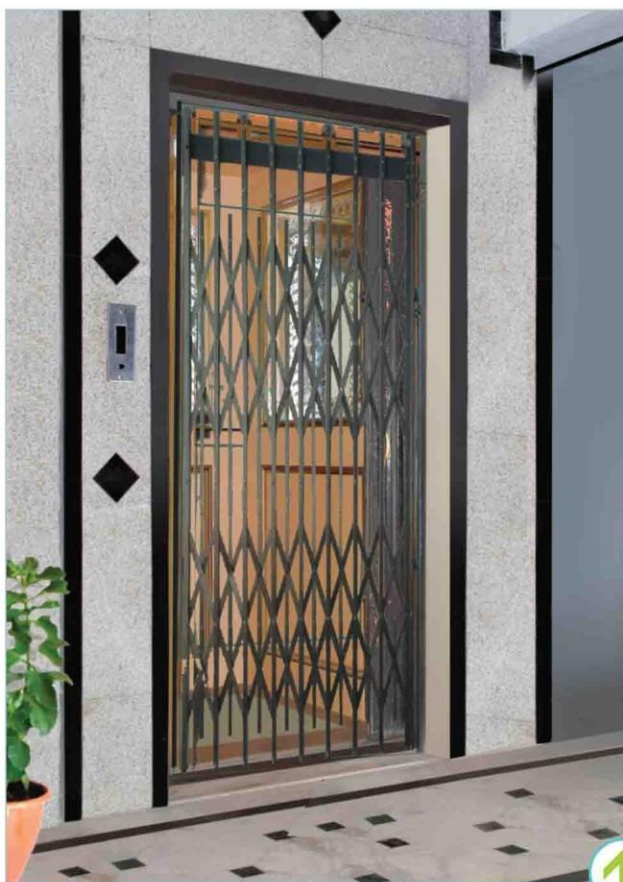

Minimum Civil Dimensions For Manual Gate Passenger Elevators

| LOAD | | SPEED | CAR INSIDE | | LIFT - WELL | | ENTRANCE | MACHINE ROOM | | PIT DEPTH | OVER HEAD |
|---------|-----|----------|------------|------|-------------|------|----------|--------------|------|-----------|-----------|
| PERSONS | KG. | (M.P.S.) | A | B | C | D | E | K | L | S | S |
| 4 | 272 | 0.63 | 820 | 910 | 1200 | 1350 | 700 | 1650 | 3500 | 1350 | 4000 |
| 5 | 340 | | 1170 | 820 | 1600 | 1200 | 760 | 1600 | 3350 | | |
| 6 | 408 | | 1170 | 940 | 1600 | 1400 | 760 | 1600 | 3550 | | |
| | | | 1050 | 1050 | 1450 | 1500 | 700 | 1900 | 3650 | | |
| | | | 950 | 1150 | 1350 | 1600 | 700 | 1800 | 3750 | | |
| 8 | 544 | | 1300 | 1100 | 1800 | 1500 | 760 | 2250 | 4000 | | |

* 700 With imperforated doors

\$ For West Bengal code refer to 'Otis'

Notes :- 1) Dimensions comply with Bureau of Indian Standard Specifications.

2) The automatic door elevator configurations are based on 2 panel centre opening doors.



Top technology creates brand-new riding experience

Passenger Elevator Auto Door

- The passenger elevators detailed here are designed to handle promptly and efficiently the transportation requirements of any type of building-which means any traffic condition.
- They are renowned for fine quality and robust performance.
- Delivers maximum lifting power with a minimum of effort.
- A superior combination of flexibility and performance.
- It gives benefits of jerk less traveling, economically low power consumption and excellent design.
- Features : Cent percent safety, Easy to use and maintain.



Minimum Civil Dimensions For Autodoor Passenger Elevators

| LOAD | | SPEED | CAR INSIDE | | LIFT - WELL | | ENTRANCE | MACHINE ROOM | | PIT DEPTH | OVER HEAD |
|---------|------|-------------|------------|------|-------------|------|----------|--------------|------|-----------|-----------|
| PERSONS | KG. | (M.P.S.) | A | B | C | D | E | K | L | S | S |
| 6 | 408 | 0.70 | 1200 | 910 | 1600 | 1525 | 700 | 1600 | 3550 | 1350 | 4000 |
| 8 | 544 | 1.00 | 1300 | 1100 | 1800 | 1800 | 800 | 2250 | 4100 | 1600 | 4300 |
| | | 1.50 | | | | | | 3300 | 4300 | | 4400 |
| 10 | 680 | 1.00 & 1.50 | 1350 | 1300 | 1800 | 2000 | 800 | 3300 | 4500 | | |
| 13 | 884 | 1.00 & 1.50 | 2000 | 1100 | 2500 | 1800 | 900 | 4000 | 4300 | 2500 | 5400 |
| | | 2.50 | 2000 | 1100 | 2500 | 1900 | 900 | 4000 | 4400 | | |
| 16 | 1088 | 1.50 | 2000 | 1300 | 2500 | 2100 | 1000 | 4000 | 4600 | 1600 | 4400 |
| | | 2.50 | 2000 | 1300 | 2500 | 2100 | 1000 | 4000 | 4600 | 2500 | 5400 |
| 20 | 1360 | 1.50 | 2000 | 1550 | 2500 | 2400 | 1000 | 4000 | 4900 | 1600 | 4400 |
| | | 2.50 | 2000 | 1550 | 2500 | 2400 | 1000 | 4000 | 4900 | 2500 | 5400 |

* 700 With imperforated doors. \$ For West Bengal code refer to 'Otis'

Notes :- (1) Dimensions comply with Bureau of Indian Standard Specifications. (2) The automatic door elevator configurations are based on 2 panel centre opening doors.



Hospital Elevator

We are manufacturing stretcher elevators of various capacities & speeds to suit customers' requirement. The cabin we provide for patients, are spacious & very comfortable with proper exhaust system and jerk free stopping . It is also designed to transport bulky hospital equipments. Versatile automatic control system is provided to permit economical self service or an attendant operation. Emergency control system makes the lift reliable and safe.

- Bed Elevators a purpose designed solutions for hospitals and renowned for fine quality and robust performance.
- A wide range of Car dimensions is available for the varying requirements of a modern hospital.
- The entire system is Safe reliable and operating Steadily.
- Features : Accurate Open and Shut Control, Stable and Smooth.

Safety Door Edge (SDE) (Standard)

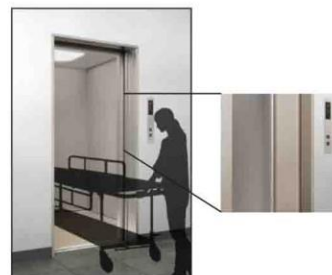

A mechanical safety device with a micro-switch reverses closing doors if there is physical contact with a passenger or an object.





Hospital Elevator

A full range of people and
goods flow solutions for
demanding medical facilities

Easy access with strollers,
luggage and wheelchairs.

Wide opening elevator doors
and accurate leveling

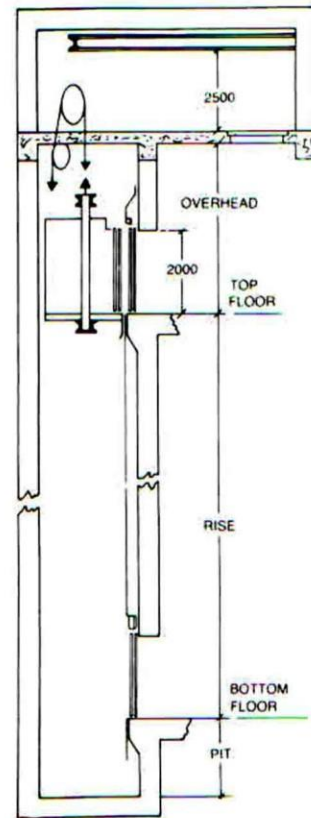

Elevation

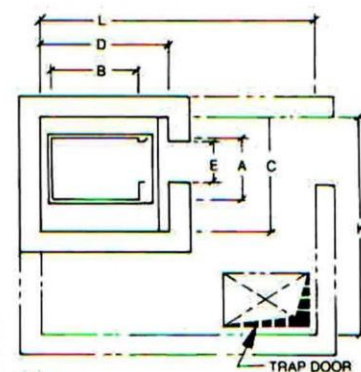

Plan

Space Requirements

| LOAD | | CAR INSIDE | | LIFT - WELL | | ENTRANCE | MACHINE ROOM | | SPEED (M.P.S.) | PIT DEPTH | OVER HEAD |
|---------|------|------------|------|-------------|------|----------|--------------|------|-------------------|--------------|--------------|
| PERSONS | KG. | A | B | C | D | E | K | L | | | |
| 15 | 1020 | 950 | 2400 | 1700 | 3000 | 800 | 3700 | 5500 | Upto 1.5 | 1600 | 4400 |
| 20 | 1360 | 1300 | 2400 | 2200 | 3000 | 1200 | 4200 | 5500 | | | |
| 26 | 1768 | 1600 | 2400 | 2350 | 3000 | 1200 | 4350 | 5500 | Over 1.5 | 2500 | 5400 |



Automobile Elevator



Car elevators help to alleviate the problems of finding sufficient parking space in busy areas, and save on costly land in commercial spaces. These lifts smoothly transport vehicles to the top of building, or to basements and showrooms.

They are carefully engineered for independent access of vehicles in private homes or multi-family residences where space is valuable.

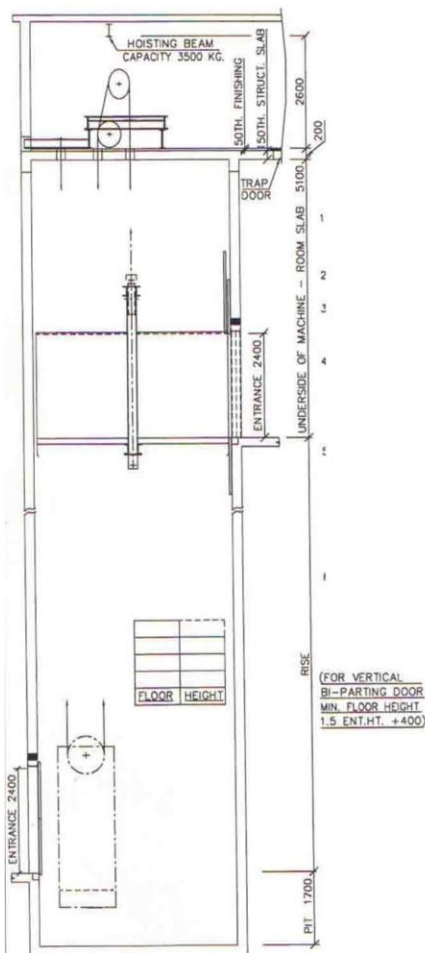

Elevation

Owner's Work

1. All Walls Minimum 150 RCC Or 230 Brick (H/Y Front Wall 230 Bk Preferred)
2. All Civil Work, Holes, Grouting Etc.
3. Dry Pit Reinforced to Sustain Total 56000 Kg Reaction Load.
4. Reinforced Concrete Machine - Room Structural Floor Slab 150 Thick Designed to Sustain Min. 1000 Kg. / M² U.d.l.
5. Steel Material :- Hoisting Beam, Machine Beams, Hitch Beams, Support Beams, Gov. Support, Bearing Plates, Pit - Ladder And Stanchions
6. Power Supply 400 Volts, 3 Phase, 4 Wires, 50 Hz & 230 Volts 1 Phase.

(For Vertical Bi - Parting Door, Min, Floor Height 1.5 Ent. H.T. + 400)

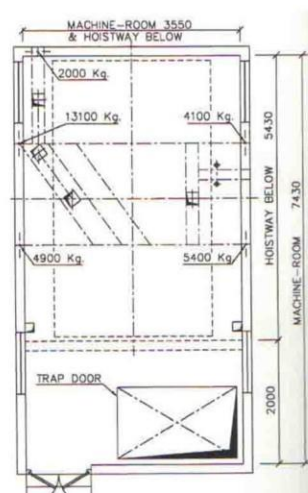

Machine Room Plan

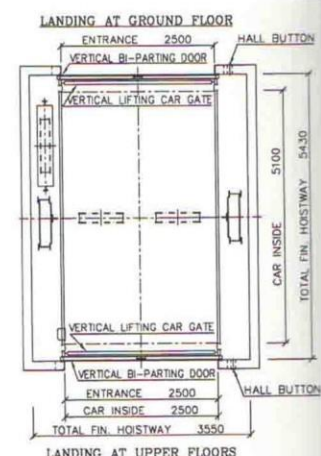

Hoistway Plan



A New Level of Parking Freedom

Stack Parking System



For best use of available room height the ARKOWN stack park system provides you with an ideal combination of long-term and short-term parking.

The system is equipped with a single platform, allowing long-term parking on the upper level and short-term parking on the lower one. For use of the upper platform remove the vehicle from the lower parking space.

This system can also be retrofitted into existing buildings.

- Surface mounted - no construction
- Single (220 / 240V) or three phase (380/415V)
- Variable platform rise to suit your vehicles
- Corrugated box heavy duty platform
- Low voltage push button control panel
- Automatic mechanical locking
- Manual Lowering in event of power failure
- Lowering speed regulated by control valve
- Suitable for exterior & garage installation

Stack Parking System

| MODEL | L | Wide | A | B |
|----------|------|------|------|------|
| SHP-D170 | 3700 | 2300 | 1700 | 3800 |
| SHP-D190 | 4500 | 2300 | 1900 | 4000 |
| SHP-D200 | 5000 | 2300 | 2000 | 4100 |
| SHP-D220 | 5000 | 2300 | 2200 | 4300 |

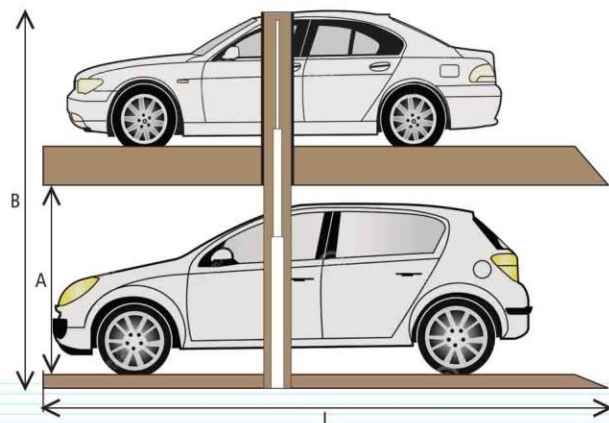

Before Purchasing A Arkown Stack Car Parking System:

- Consultation at our company office or at the dealer's office in region
- Garage layout check for your individual offer

Power

- We carry out the electrical wiring for parking system

We Perform:

- On-site measurements for final dimensions assessment
- Transportation to construction site
- On-site assembly

System Equipment & Versions :

- Low-noise unit
- 1 Key per parking space
- Platform load 2.0 metric tons
- Corrosion protection
- Platform width, standard, compact, exclusive
- Necessary safety railings at parking systems

**PARKING & STACKING
STACKING & STORAGE
INDEPENDENT PARKING
MONO GOODS LIFT**

Home Elevator



It's Not Just a Lift It's a Life Style

- Add's value to your home.
- Precisely designed for your home.
- Noiseless.
- Smooth ride and Smooth final stop.
- Its elegant design, easy to install as well as safe and easy mobility from basement to the attic, with the push of a button.
- It is the ideal solution for elderly and physically challenged person to move autonomously and free from Stairs.

40%
ENERGY
SAVE
Gearless Machine



Suitable only for Personal use in
Home / Villas with standard Lift Cars.



Home Elevator



HOISTWAY PLAN LAYOUT

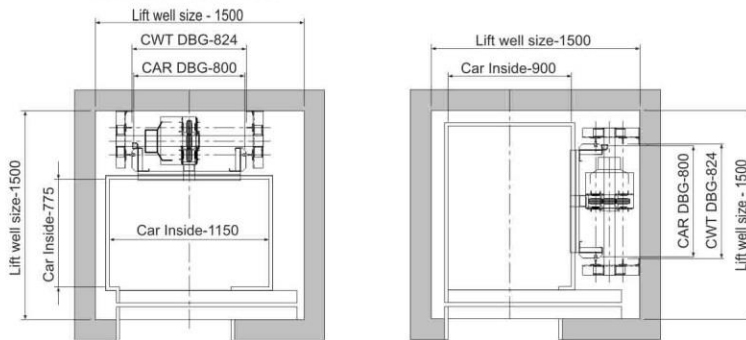

HOISTWAY ELEVATION DRAWING

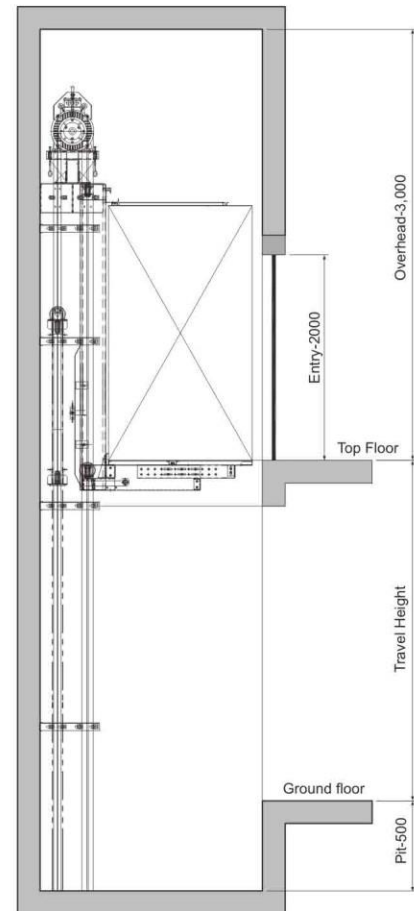

SPECIFICATION

| | | | |
|-----------|-------------------|------------------|----------|
| RPM | 120 | Pulley Dia. | 100 mm |
| Frequency | 12 Hz. | Rope Dia. | 4 mm |
| Voltage | 230 VAC | No. of Ropes | 4 |
| kW / Hp | 0.75 / 1 | Lifting Capacity | 300 kg |
| Weight | 70 kg. | Lift Speed | 0.32 m/s |
| Brake | Pick-up : 220 VDC | Max. Travel | 15 Mts. |
| Voltage | Holding : 110 VDC | Starts / Day | 100 |

All Dimensions are in mm.
This is General Data, it may be changed without notice.



General Comparison Between Hydraulic & Gearless Installation

HYDRAULIC

- Noisy Due To High Rpm of Motor
- Stopping & Starting Jerky and Changes With Temperature
- Delayed Response to Car & Landing Calls
- Performance Varies Greatly With Seasonal Changes in Temperature
- Due To Valve Leakage, When Stationary, Car Loses Level And Pump Is Started To Relevel The Car. This Leads To Power Wastage And Creates Noisy Nuisance To The Household, Particularly At Night
- Generally 70 Switching / Hour Without Heat Exchanger
- Equipment Is Imported
- Requires About 200 To 300% More Power Than Gearless Installation
- Could Be Messy Due To Spillage Of Oil
- Requires Oil, Is Potential Threat To Soil

GEARLESS

- Silent Due To Low Rpm of Motor
- Acceleration & Deceleration Smooth and Constant
- Quick Response to Car & Landing Calls
- Performance Constant in All Seasons
- When Stationary, Car Does Not Lose Level At Any Time
- Upto 180 Switching / Hour
- Equipment Is Indigenously Manufactured And Is Exported
- Power Saver, Due To High Efficiency Of Installation
- Clean And Neat Installation
- Eco-friendly - does Not Require Oil For Working



MRL Elevator

Machine Roomless Elevator



Best in class **Eco-Efficiency**

It reduces the building expense and saves the construction cost too

Machine Roomless Elevator gathers together the excellent ARKOWN lift system and the research fruits of the architectural adaptability. It has been independently researched into and developed by ARKOWN company. It adopts the mature control technology and the advanced design concepts that lead the trend with a combination of the superior performance permanent magnet synchronous and gearless drive system. It completely merges with the constructions to fully hoist the building aesthetics and values. It has very high cost performance advantages ARKOWN Machine Roomless Elevator is just like the eyes of the architecture. It thoroughly shows the construction characteristics.



HOISTWAY ELEVATION DRAWING

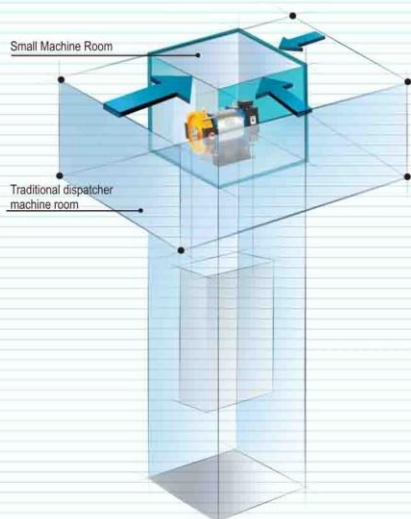
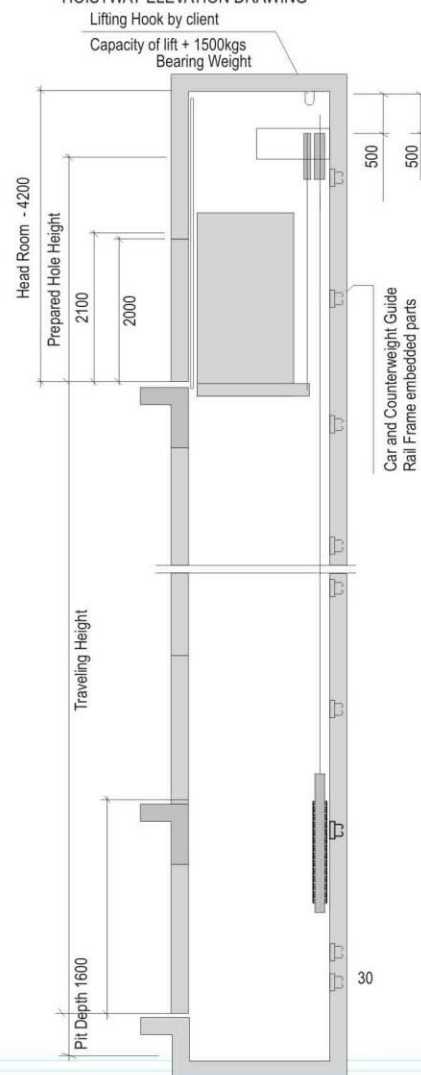



MRL Elevator

Machine Roomless Elevator



The Revolutionary MRL Elevator Concept

"Core" of Energy - Saving
Permanent Magnet Synchronous and
Gearless Traction Machine



"Light" of Low-Carbon
A Forerunner of LED Car Lighting Source

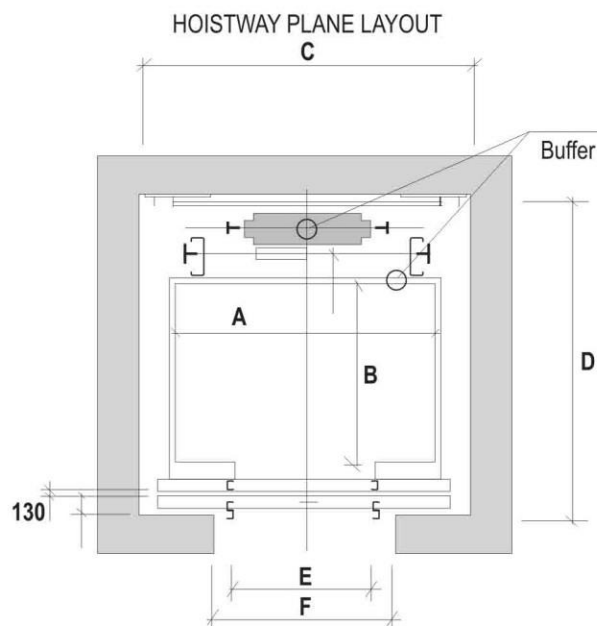

HOIST WAY MACHINE ROOM SIZES

| Person | Capacity KGS | Lift Well | | Car Inside | | Clear Entrance E | Clear Opening at landing | |
|--------|-----------------|-----------|------|------------|------|---------------------|--------------------------|------------------------|
| | | C | D | A | B | | F Auto Door | F Manual Telescopic |
| 6 | 408 | 1800 | 1400 | 1200 | 900 | 700 | 780 / 2100 | 1450 / 2350 |
| 8 | 544 | 1900 | 1600 | 1300 | 1100 | 800 | 880 / 2100 | 1600 / 2350 |
| 10 | 680 | 1900 | 1800 | 1300 | 1300 | 800 | 880 / 2100 | 1600 / 2350 |
| 13 | 884 | 2200 | 1900 | 1600 | 1400 | 900 | 980 / 2100 | 1700 / 2350 |

All Dimensions are in mm size.



Goods Elevator

Elevator your efficiency of Goods material handling tasks



- We provide a complete range of freight elevators of different load carrying capacity.
- Freight elevator in your building will make handling of goods easy & enhancing production.
- We supply freight elevators with dust proof equipments as per our customers' requirement.
- Directly and indirectly, modern freight elevators make for efficient operation throughout the building.
- The results of properly planned freight elevator installation show up in increased material handled volume and greater earning power.

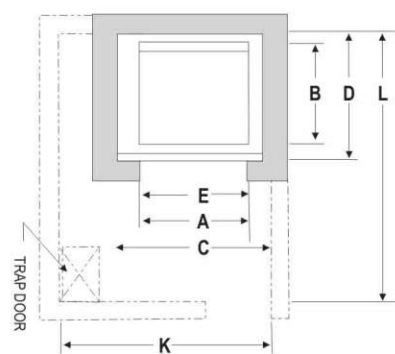

HOIST WAY MACHINE ROOM SIZES

| Capacity | Car Inside | | Lift Well | | Clear Opening | Wall Opening | Machine Room | | | Pit Depth | Over Head | Speed |
|-------------|------------|------|-----------|------|---------------|--------------|--------------|------|--------|-----------|-----------|--------|
| LOAD IN KG. | A | B | C | D | E | F | G | H | Height | | | Mt/Sec |
| 500 | 1200 | 1200 | 1650 | 1650 | 800 X 2000 | 1150 X 2225 | 2700 | 2700 | 2500 | 1600 | 4200 | 0.35 |
| 1000 | 1700 | 1600 | 2400 | 1900 | 1200 X 2000 | 1625 X 2225 | 3500 | 3000 | 2500 | 1600 | 4600 | 0.35 |
| 1500 | 2000 | 2000 | 2700 | 2300 | 1500 X 2000 | 2000 X 2225 | 4000 | 4000 | 2500 | 1600 | 4600 | 0.35 |
| 2000 | 2200 | 2500 | 2900 | 2800 | 1500 X 2000 | 2000 X 2225 | 4000 | 4200 | 2500 | 1600 | 4600 | 0.35 |
| 2500 | 2500 | 2500 | 3200 | 2800 | 1600 X 2000 | 2100 X 2225 | 4500 | 4500 | 2500 | 1600 | 4800 | 0.35 |
| 3000 | 2500 | 3200 | 3300 | 3500 | 1600 X 2000 | 2100 X 2225 | 4500 | 5200 | 2500 | 1600 | 5200 | 0.35 |
| 4000 | 2500 | 4000 | 3400 | 4300 | 2000 X 2000 | 2600 X 2225 | 4500 | 6300 | 2500 | 1600 | 5200 | 0.35 |

HOISTWAY ELEVATION & PLANS

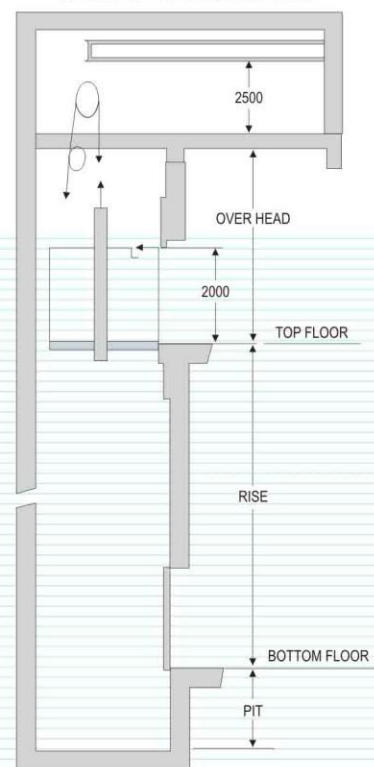



Hydraulic Elevator

For Low Rise

Outstanding Quality Safe and Reliable



Hydraulic Passenger / Goods Elevators Manual / Auto door for Residential, Commercial, Hotel, Clubs, Bungalows & Industrial buildings depending upon the shaft size & convenient machine room less movement of men, material & vehicles. With speed / amenities up to choice of owners.



| PERSONS | 6 | 8 |
|---------|---------|---------|
| LOAD | 408 KG. | 544 KG. |
| A | 1000 | 1100 |
| B | 1100 | 1300 |
| C | 1600 | 1900 |
| D | 1700 | 1800 |
| E | 700 | 800 |

Owner's Work

1. All Wall Minimum 230 Brick or 150 Rcc (H.Y. Front Wall 230 BK. Preferred)
2. All Civil Work, Holes, Grouting Etc.
3. Dry Pit Reinforced To Sustain Total 16300 Kg. Reaction Load.
4. Steel Material Hoisting Hooks, Pit Ladder, Etc.
5. Power Supply 400 Volts, 3 Phase, 4 Wires, 50 Hz & 230 - Volts 1 Phase

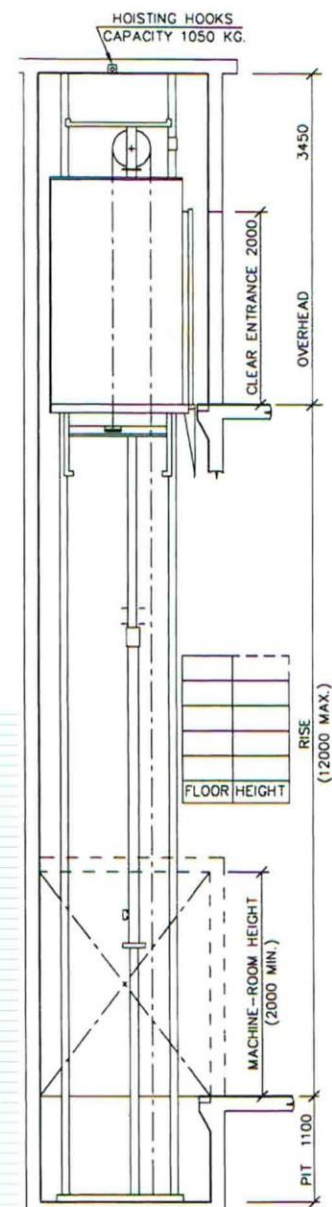
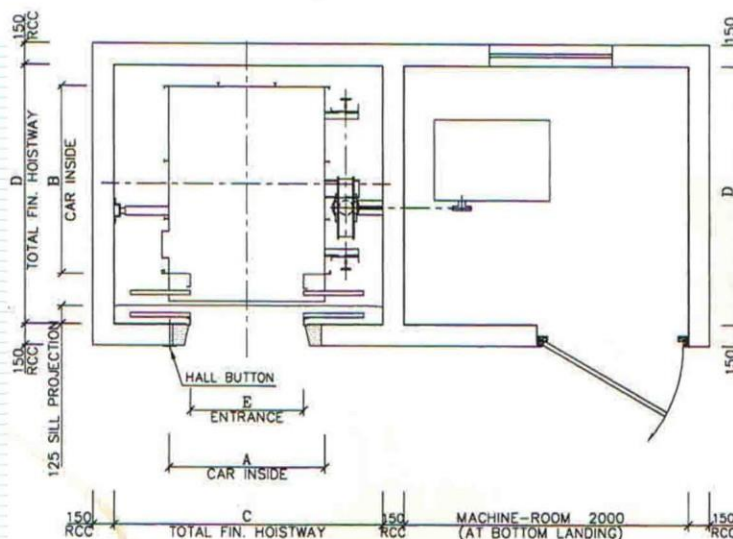

DOOR DESIGNS

Door Designs

Manual Door



M.S. Collapsible door



M.S. Powder Coated Imperforated Door



Manual Powder Coated Telescopic Door



M.S. Powder Coated Swing door



M. S. Telescopic Doors



M.S. Powder Coated Frame Full Glass Swing Door

Series Door Headers



2-PANEL SIDE OPENING Car Door Mechanism

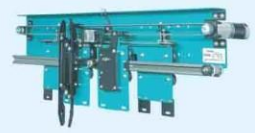

4-PANEL CENTRE OPENING Car Door Mechanism



2-PANEL CENTRE OPENING Landing Door Mechanism

Automatic Door



Center Opening Hairline Finish



Stainless Steel Designed Finish Auto Door



Stainless Steel Hair line Finish Auto Door



Glass With Stainless Steel Framed Finish Auto Door



Cabin Designs



M.S. Powder Coated Finish Car.



Stainless Steel Hairline Finish Car.



Titanium Gold Designed With Stainless Steel Finish Car.



Stainless Steel with Mirror Finish Car.



Stainless Steel with M.S. Colour Powder Coated Car.



S.S. with Glass cabin

ETCHING S.S. FINISH

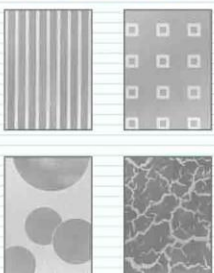

ETCHING GOLD FINISH



Titanium Gold Finish Car



M.S. Powder Coated & Glass Car



S.S. Powder Coated & Glass Car

LOP & COP

COP & LOP

Car Operating Panel & Landing Operating Panel



PUSH BUTTONS

Car Operating Panel

Designs Layout available stainless steel hair line finish position indicator

7 Segment Dot Matrix LCD. TFT.



COP- A01



COP- A02



COP- A03



COP- A04



LIP - 01



TFT SCREEN DISPLAY



LIP - 02



LOP- A05



LOP- A06



LOP- A07



LOP- A08

Components



Over Load System



Limit Switch



Inspection Box



R.R. Cam



Thimble



gearless machine

Elevator Machine

Arkown can supply you with a complete line of high - performance motors and drives systems to keep your elevator in motion, and performing to specification.



Gearless Home Lift Machine



MRL Gearless Machine



MRL Gearless Machine



geared machine



Compact Traction Machine



BT Traction Machine

CONTROL PANEL (REGULAR / VVV3F)



- Automatic Door Speed Control
- Automatic Door Open time Adjustment
- Door Load Detector
- Safety door edge on both side
- Ultrasonic door sensors
- Safe Landing / next landing
- Continuity of Service
- Automatic Bypass
- Automatic landing call registration
- False call cancelling
- Car light / fan shut off automatic

Automatic Rescue Device (ARD)



The (ARD) is the safest automatic elevator evacuation device designed for VF Elevators. The ARD relates to a new concept and design and operates the elevators controller at rated voltage to perform the evacuation operation.

Salient Features

- Controller is housed in a sleek compact floor mounted Cabinet with hinged doors.
- Microprocessor based control and space vector modulated Inverter.
- State of the art Battery charger with four charging modes - Trickle, Bulk, Float and Full. Operates on 3-Phase, 400V, 50 Hz Power.
- The smart Rescue is the safest evacuation device as it has no interface with safety circuit.
- No interface with any operating component of elevator - Motor, Brake, Door Operator, R Cam, etc.

MRL Panel



Smooth



Variable Frequency AC Drive

SPECIFICATION

Specification

| Features | Manual | Automatic |
|--------------------------|---|--|
| Capacity | 4,5,6 & 8 | 4,5,6 & Above |
| Drive | VVf | VVf |
| Drive Speed | 0.7 M / s | 0.7 To 1.5 M / s |
| Control | Micro Processor Based Control System A) Simplex Collective Down | Micro Processor Based Control System A) Simplex Collective Down B) Simplex Collective Selective C) Duplex Collective Down D) Duplex Collective Selective |
| Car Door | A) Telescopic Door B) Imperforated Door | A) Telescopic Door B) Centre Opening Door |
| Landing Door | A) Telescopic Door B) Imperforated Door C) Swing Door | A) Telescopic Door B) Centre Opening Door |
| Car Panels, Car Flooring | Stainless Steel / Painted MS Anti - skid PVC / Granite / Vitrified Tiles | |
| Standard Features | Direction Arrows and Position Indicators In Landing 7 Segment Position Indicator And Direction Arrows In Car Fan And Light In Car Emergency Light and Alarm Door Open Warning Buzzer for Manual Doors | |
| Special Features | Infrared Screen For Automatic Doors VVf Door Drive System Mirror In Car | |
| Optional Features | Intercom Communication Stainless Steel Handrail Automatic Rescue Device Attendant Service Operation | |
| Electric Power Required | 3 phase 415 AC. with neutral 50 Hz | |

We are technically Preferred the Following Brands.





Corporate Responsibility

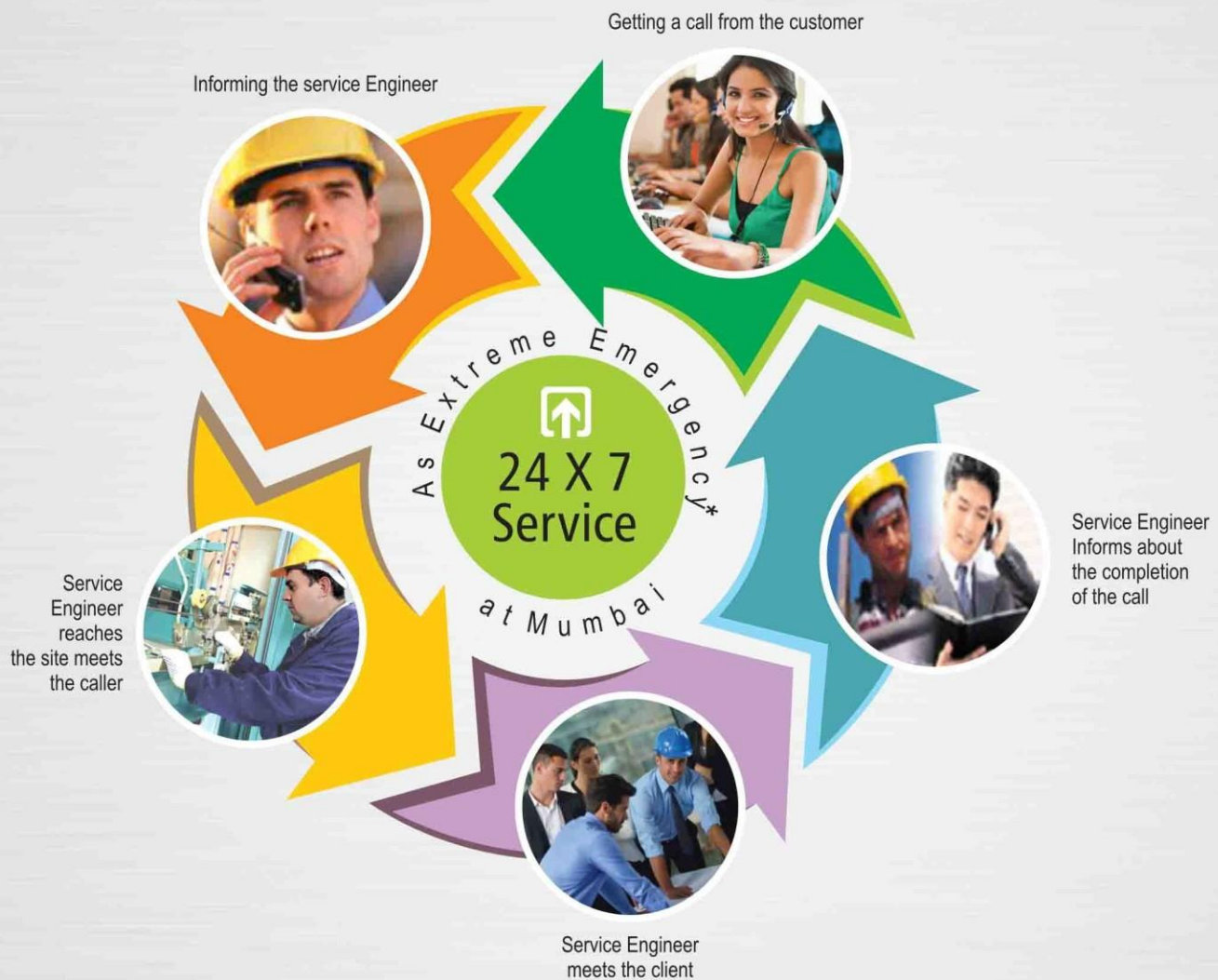

24
HOURS

for Extreme
Emergency

ARKOWN promises good repair and maintenance services



Fast Service
* Conditions Apply



Certified ISO 9001 : 2008



New Installation Lift & All Types of Elevator Maintenance & Modernisations



ARKOWN[®]
ELEVATORS

Corp. Reg. Office :
ARKOWN ELEVATORS PVT. LTD.
(ISO 9001 : 2008 Certified)
Office No. 25, Seawood Heritage,
Plot No. 50, Sector - 04,
Kharghar, Navi Mumbai - 410 210

Works :
141/1/2, Vishal Estate, Opp. Bharat Party Plot,
NH No. 8, Ameraiwadi, Ahmedabad - 26

Phone : + 022 6575 1234
Mobile : + 91 88797 73654, 90290 14360

E-mail : arkownelevators@gmail.com
sales@arkown.com

Website : www.arkown.com

Product Available at all over Maharashtra & Kerala
and any other part of India plus abroad.

All images shown in this brochure is for imaginary purpose only & Arkown reserve the right to change any part of these specifications without prior notice.

